

# Kakadu

## RETRACTING FLYSCREEN ROLLER DOOR



210cm  
WIDTH



Approx.  
1 Hour  
Install



2 Person  
Install

1300 155 355  
info@pillarproducts.com.au  
www.pillarproducts.com.au

### COMPONENT LIST

Roller Cassette

(A) x2

(A1)

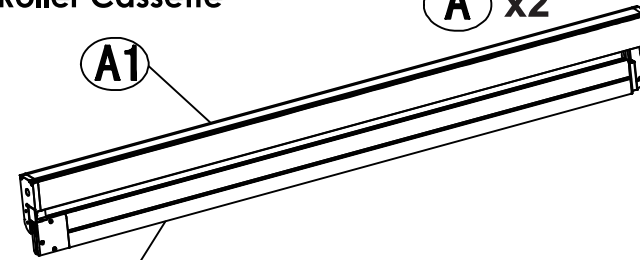

(A2) Handle profile

(F) x9

M4X25

(G) x9

M4X20

(H) x8

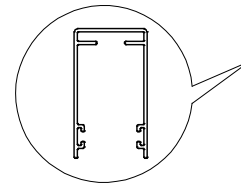

(C) x1  
Top Rail

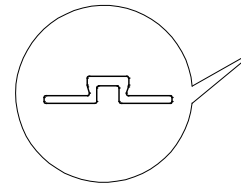

(D) x1  
Bottom Guide

Handle  
(K) x4

Cassette Clip  
(E) x6

### TOOLS REQUIRED

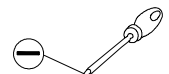
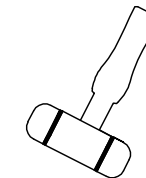
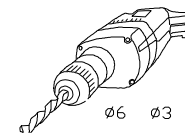
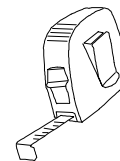
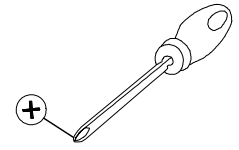
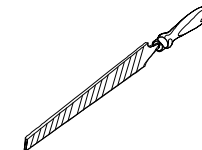
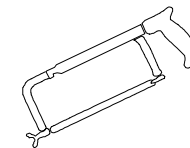

1

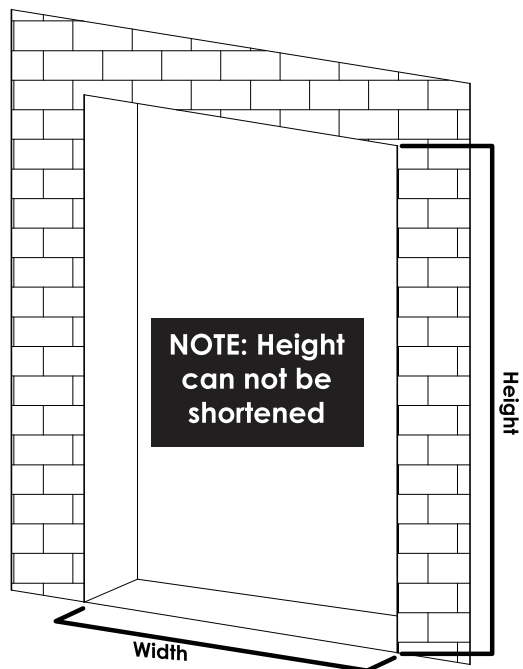

Measure opening Width and Height to ensure correct size door is selected.

2

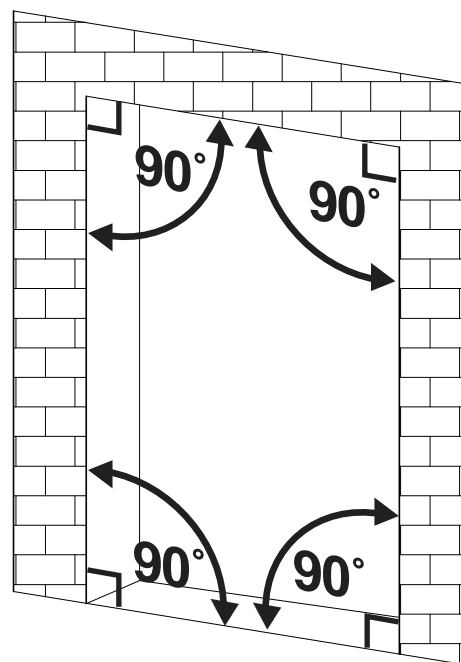

Opening **MUST** be **FLAT, LEVEL** and **SQUARE**.  
Door will not operate properly if installed out of square

3

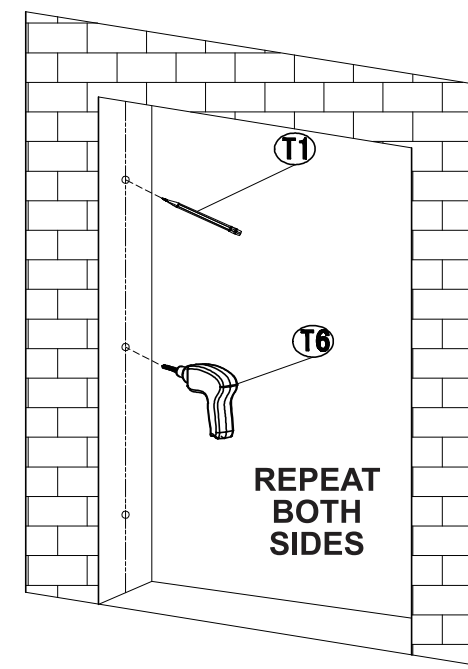

Measure, mark and pre-drill clip positions at even intervals. Use plugs if required.

4

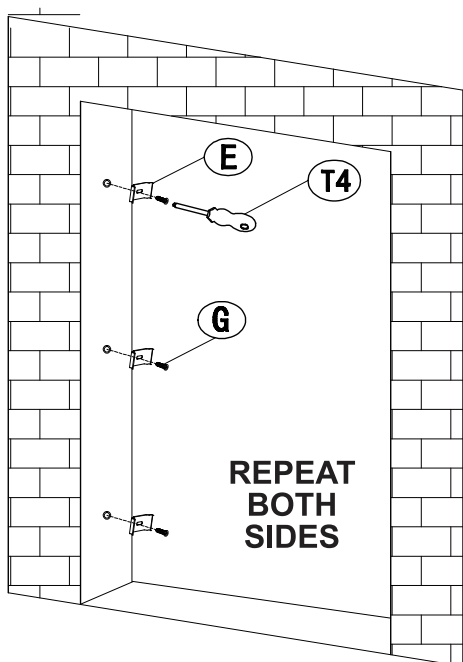

Attach Cassette Clips using screws provided at pre-drilled positions.

5

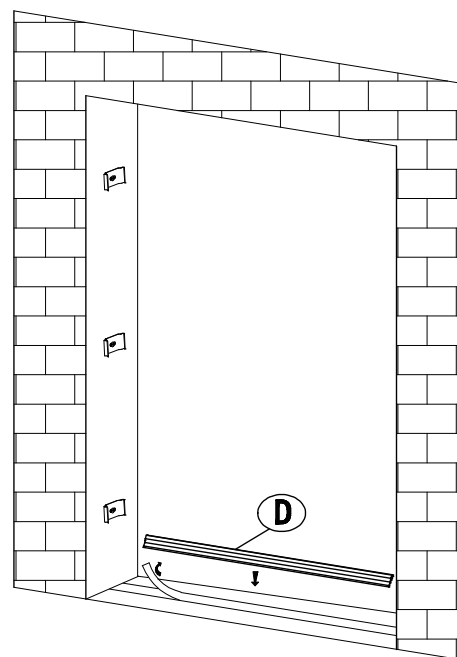

Attach the Bottom Guide to the floor using double sided tape. Additional adhesive may be used such as silicone.

6

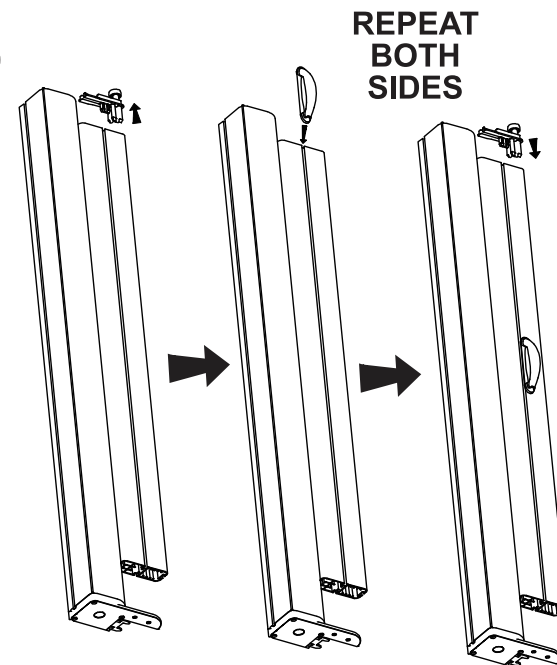

Remove the top guide to allow access for handle to slide into door & replace top guide. Secure at desired height.

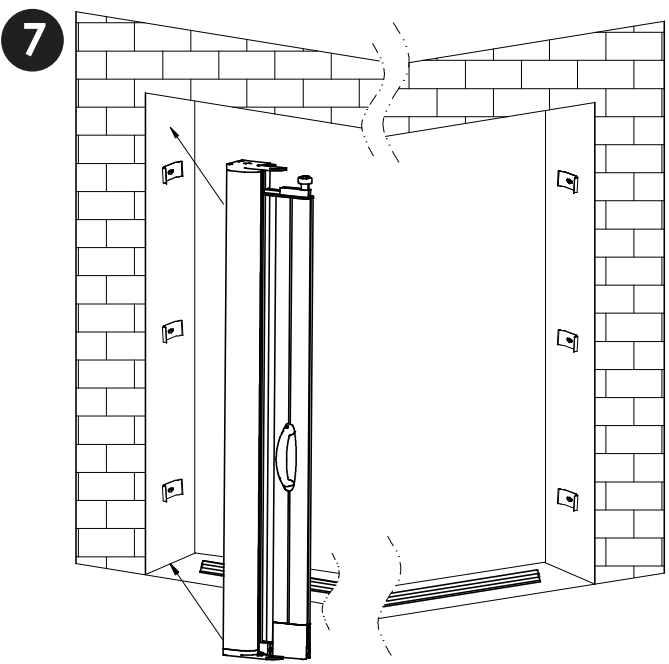

Secure left Cassette into the clips.

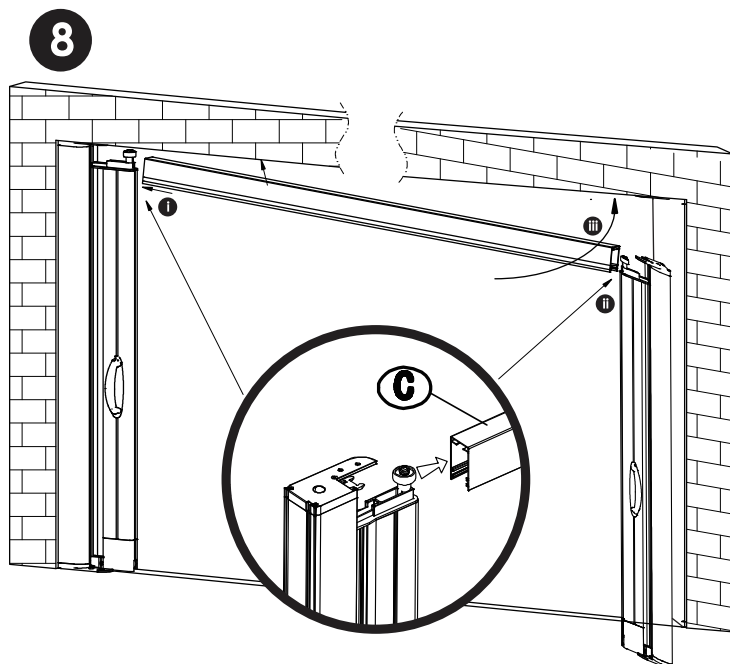

i: Insert the Top Rail over the wheel and onto the top of the Cassette as shown.  
 ii: Insert 2nd Cassette into Headrail  
 iii: Swing both Headrail and 2nd Cassette into door frame and clip into place

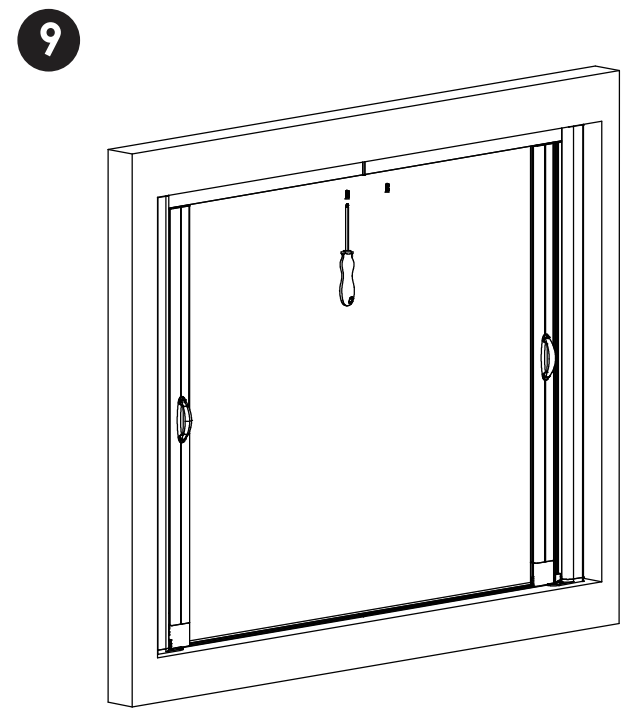

Secure Headrail into place

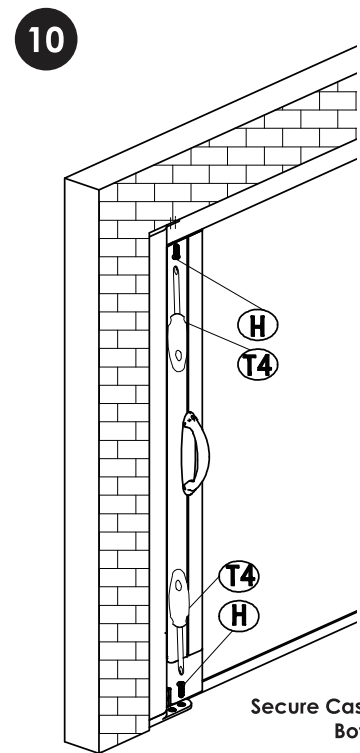

**REPEAT  
 BOTH  
 SIDES**

Secure Cassette at the additional Top & Bottom fixing points as shown.

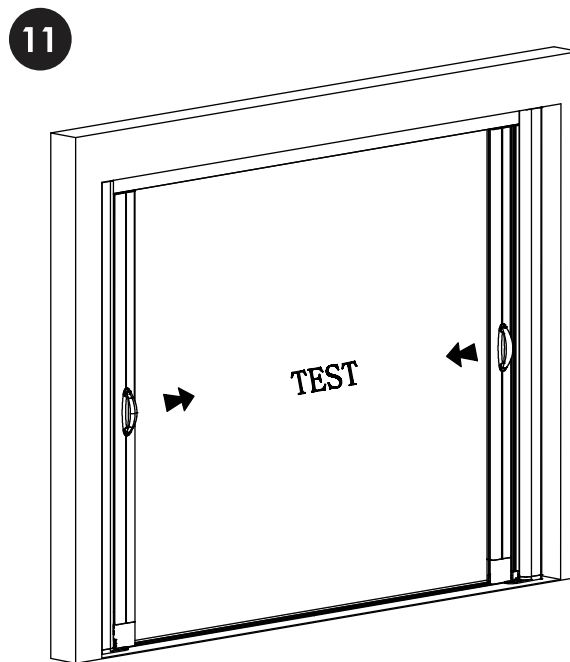

Test the door to ensure smooth operation

**See next  
 page for  
 operating  
 instructions**

# Operation

- > Door should operate freely and connect flush to magnet in opposite door.
- > If magnets do not hold, the door is not square or over tensioned/extended. Check alignment/installation.
- > Operate by hand when closing **AND opening**.
- > **Do not** release door allowing it to spring open, **control the retraction by hand**.
- > Leave door open in high winds.
- > Chain links can clip back together if they come apart from rough use.

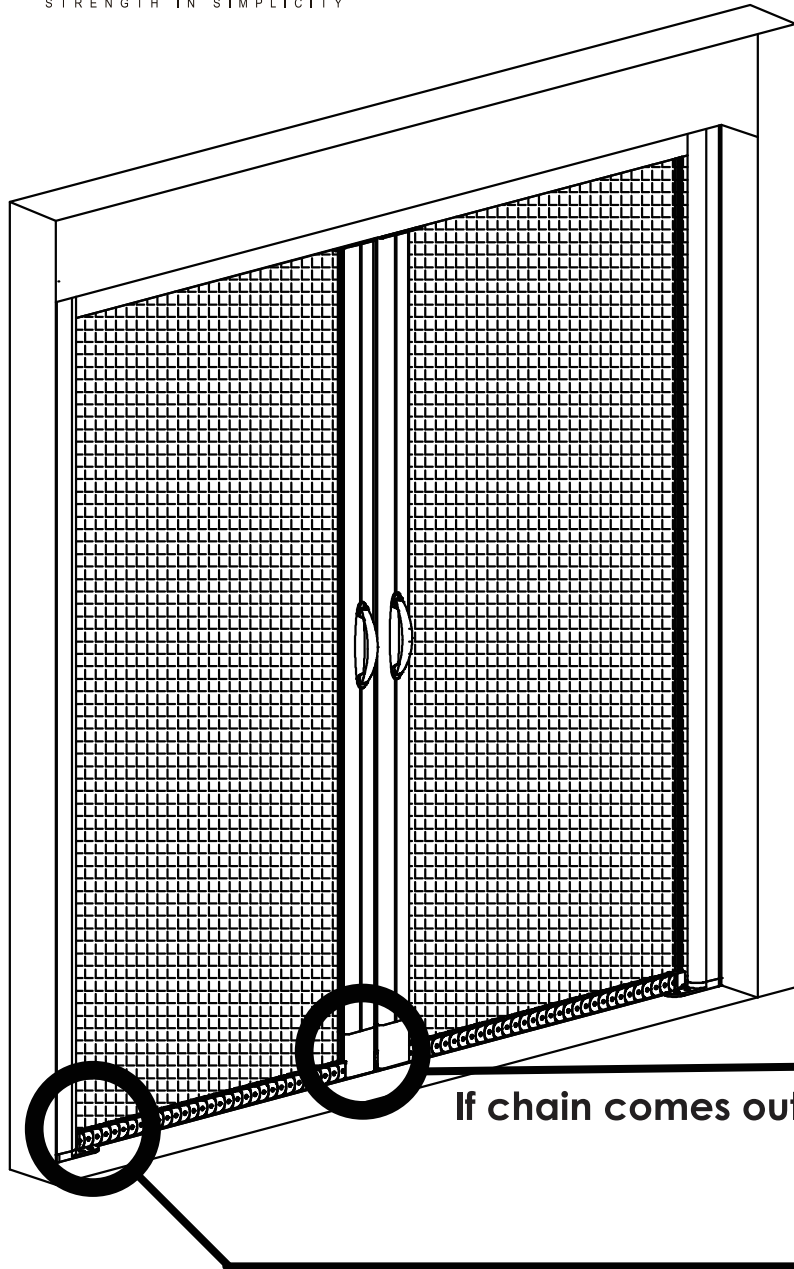

If chain comes out of Handle Bar, simply re-insert

If chain comes away from door, simply click back into place

